

**INSTALLATION INSTRUCTIONS FOR HANDLESET**

**TOOLS AND MATERIALS REQUIRED**

- Drill
- Chisel
- Tape Measure
- 3/8" (10mm) drill bit
- 1" (25mm) wood bit
- Phillips screw driver
- 2-1/8" (54mm) hole saw

Note: The important safeguards and instructions appearing in this manual are not meant to cover all possible conditions and situations that may occur. It must be understood that common sense, caution and care are factors which cannot be built into any product. These factors must be supplied by the person(s) caring for and operating the unit.

**CAUTION:** Use of manual tools recommended. When using power tools, adjust to lowest torque setting.

**1 MARK DOOR:**

Use the template enclosed to mark installation holes on both sides of door.

- Make mark for 1" (25 mm) hole on door edge

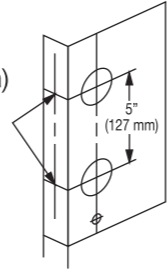

- 2 1/8" (54 mm) holes

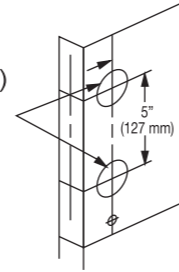

- Recommended height from floor 36" (914 mm) to 38" (965 mm)

- For distance, please refer to the template attached below.

**2 DRILL HOLES:**

Drill two 2-1/8" (54 mm) holes through both sides of door. Drill 1" (25 mm) hole deep enough to accommodate deadbolt latch. Drill 1" (25 mm) hole deep enough to accommodate spring bolt latch. Drill 5/16" (8 mm) hole for bottom screw. Note: To reduce the risk of splitting, drill holes from both sides.

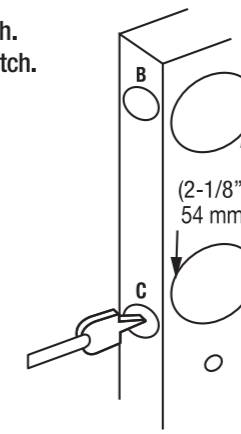
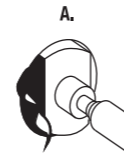

**5 INSTALL EXTERIOR HANDLE MECHANISM:**

Place exterior handle with stems and square spindle into latch as shown. Press tightly against door face.

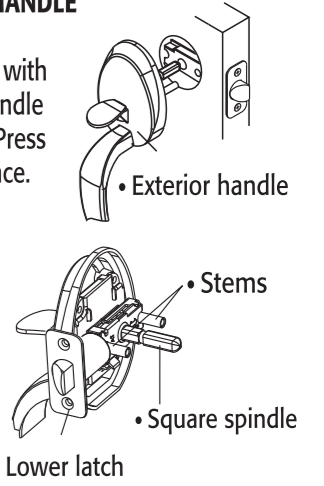

**3 INSTALL LATCH:**

Note: Cut out must be parallel with edges of door.

Install handleset spring bolt latch with desired faceplate configuration in the hole while keeping latch parallel to the door face. Mark outline and remove latch. Chisel 1/8" (3 mm) deep or until latch face is flush with door edge (only if needed). Install the latch so it will slide and lock when the door is in the closed position. Install deadbolt latch in "UP" position into the hole as shown on latch. Install screws into the holes on the faceplate only if using radius or square faceplate. On drive in latch only, use a wood block between the latch and the hammer, keep latch vertical and lightly hammer the latch in place.

**Note:** A. NEVER USE A HAMMER ON A LATCH WITH THE BOLT EXTENDED. B. DO NOT EXTEND LATCH BOLT UNTIL THE LOCK IS INSTALLED.

- Hub slot in vertical position

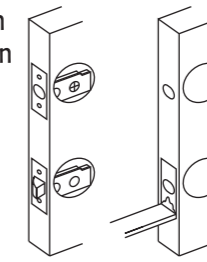

- Keep bolt fully retracted

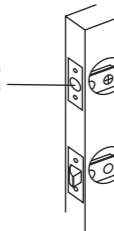

**4 INSTALL STRIKE PLATE:**

- Secure the strike plate to the door jamb using wood strike screws (BB).
- If there is no hole for the latch bolt, mark a centerline on the door jamb that aligns with the centerline of the door latch. Drill one 1" (25 mm) hole 5/8" (16 mm) deep.
- Use the strike plate to make an outline on the door jamb and chisel 1/8" (3 mm) deep until it sits flush.
- Drill two 1/8" (3 mm) drill holes and secure the strike plate to the door jamb.

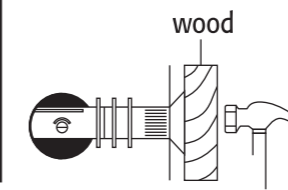
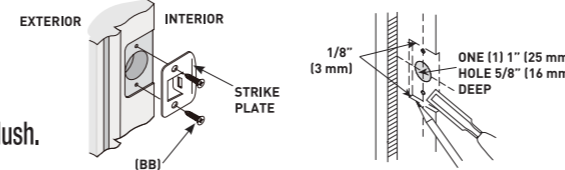

**6 INSTALL INTERIOR KNOBS:**

After exterior handle is in position, install interior knob and tighten screws. Insert screw through washer and into bottom hole tighten firmly.

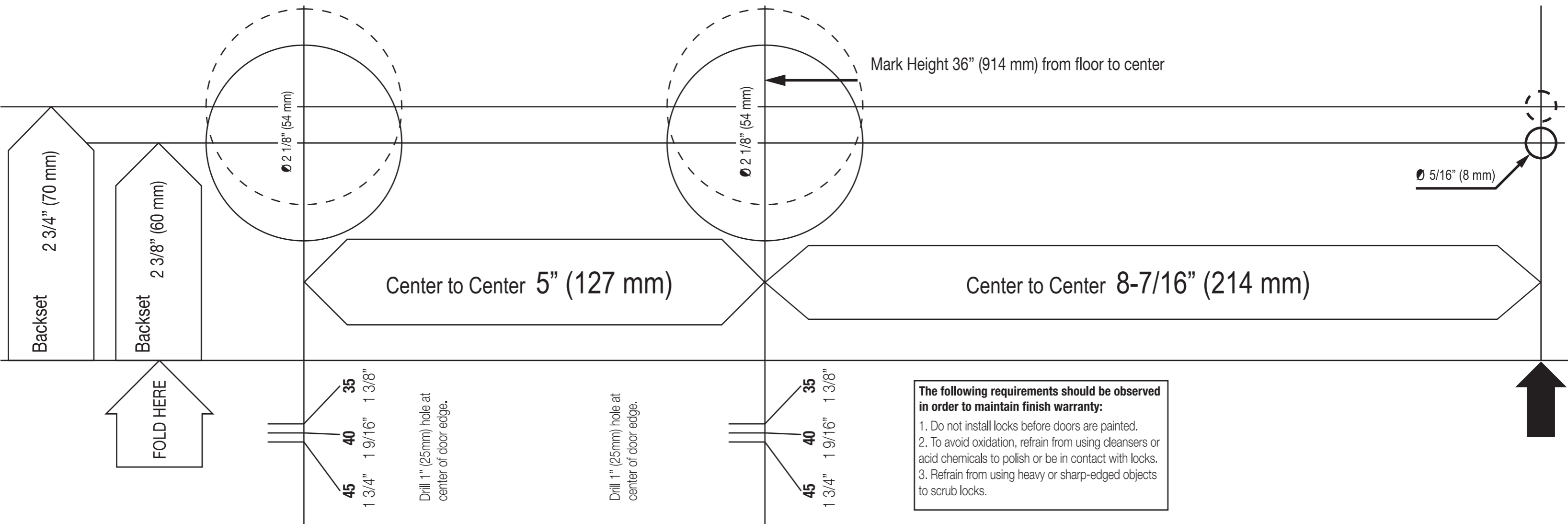
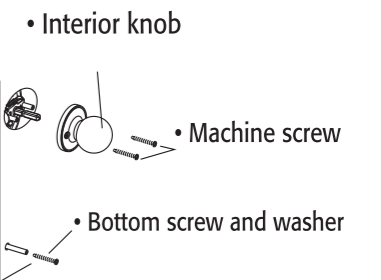

**The following requirements should be observed in order to maintain finish warranty:**

1. Do not install locks before doors are painted.
2. To avoid oxidation, refrain from using cleansers or acid chemicals to polish or be in contact with locks.
3. Refrain from using heavy or sharp-edged objects to scrub locks.